

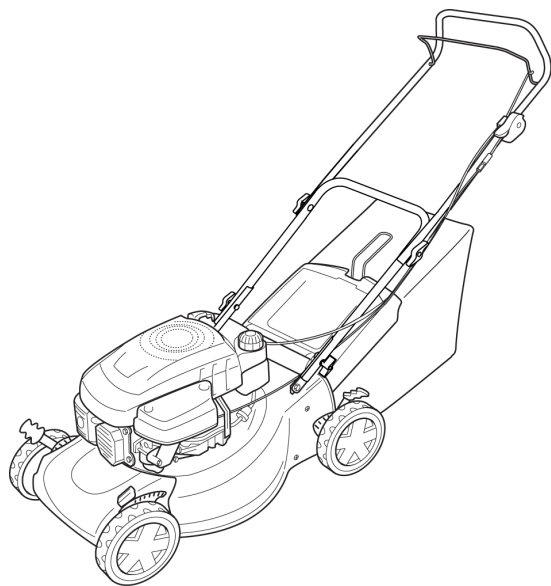

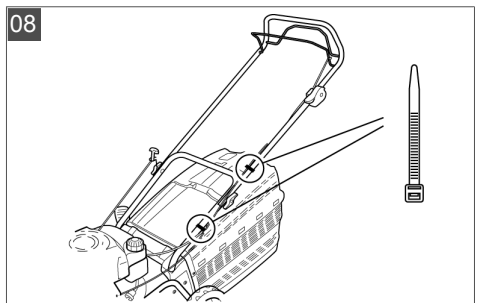

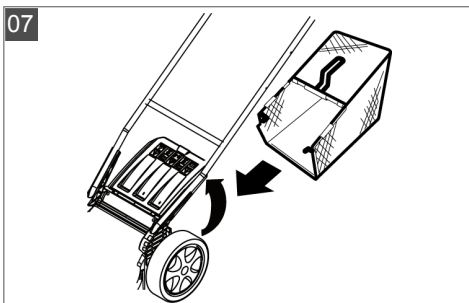

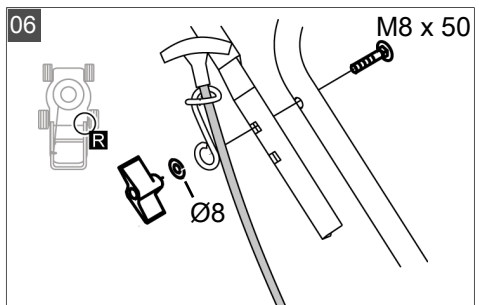
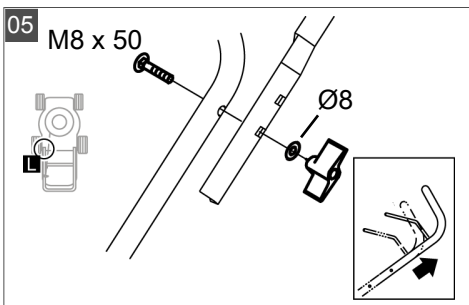
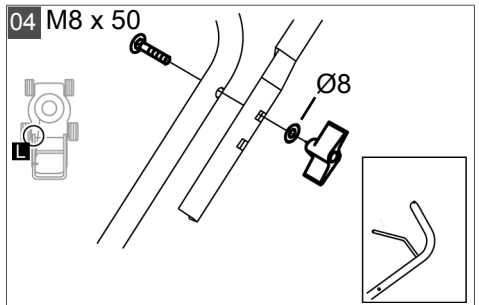
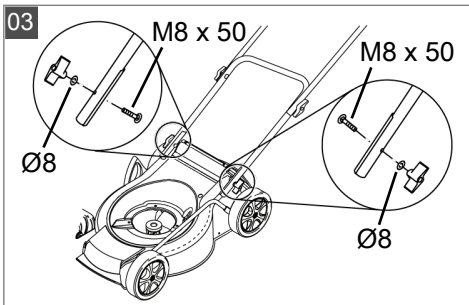
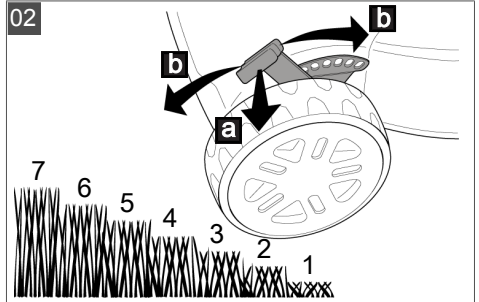
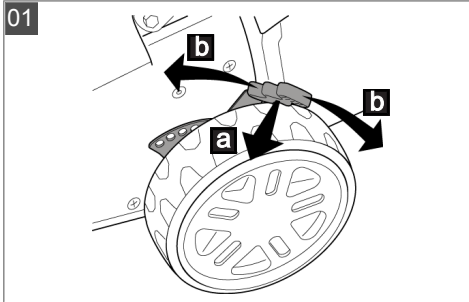

# MONTAGEANLEITUNG BENZIN-RASENMÄHER

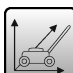
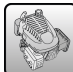
LM 46 S

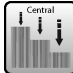



|                                                                                   |                                                                            |
|-----------------------------------------------------------------------------------|----------------------------------------------------------------------------|
|   | <b>LM 46 S</b><br><b>Art.-Nr. 113810</b>                                   |
|   | (1560 x 550 x 1050) mm                                                     |
|   | 2,5 kW<br>2850 min <sup>-1</sup>                                           |
|   | ca. 33,9 kg                                                                |
|   | 46 cm                                                                      |
|   | 30 – 60 mm                                                                 |
|   | ca. 60 l                                                                   |
|   | avhw = 6,12 m/s <sup>2</sup><br>EN ISO 5395<br>K = 1,5 m/s <sup>2</sup>    |
|   | L <sub>pA</sub> = 82,6 dB(A)<br>EN ISO 5395<br>EN ISO 11201<br>K = 3 dB(A) |
|  | L <sub>WA</sub> = 96 dB(A)<br>EN ISO 3744                                  |

**AL-KO GERÄTE GmbH** | Head Quarter | Ichenhauser Str. 14 | 89359 Kötz | Deutschland

Telefon: (+49)8221/203-0 | Telefax: (+49)8221/203-8199 | [www.al-ko.com](http://www.al-ko.com)

AL-KO Service: [www.al-ko.com/service-contacts](http://www.al-ko.com/service-contacts)