

# Elektromotor-Rasenmäher

## Tondeuse à gazon électrique EH 34 /EH 40

### Toserba elettrica

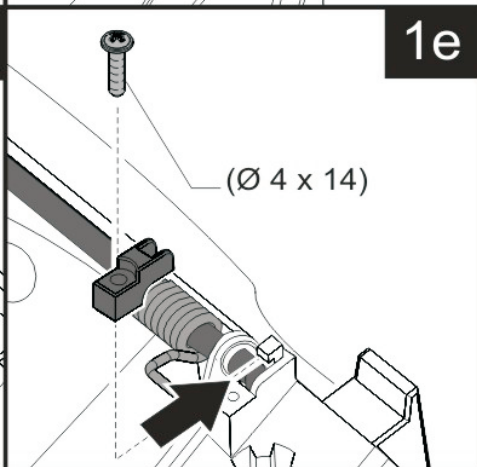

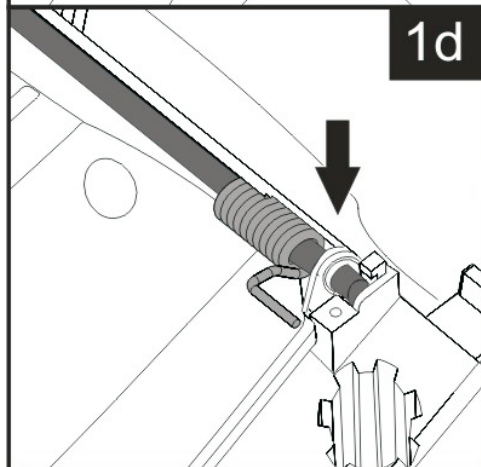
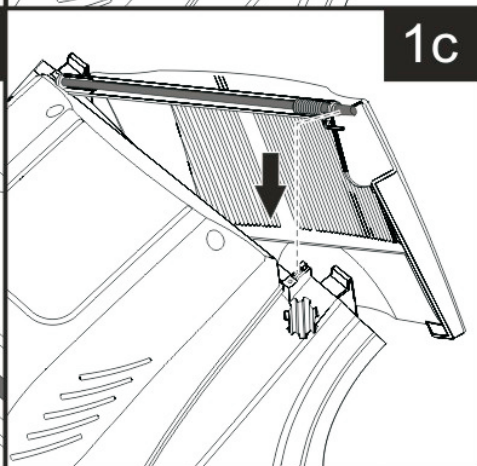
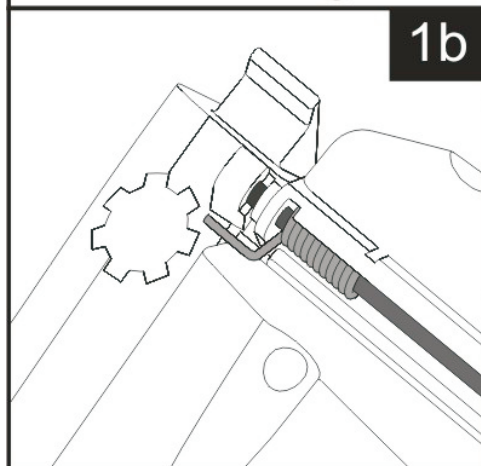
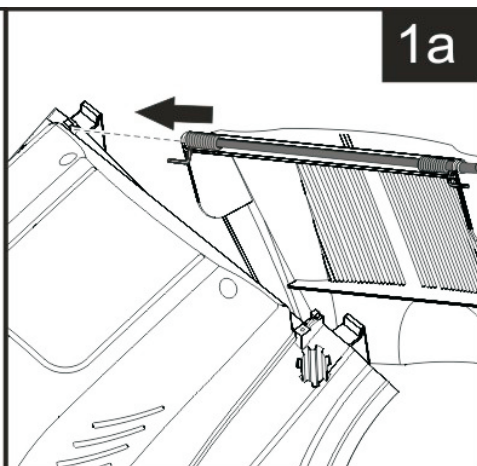
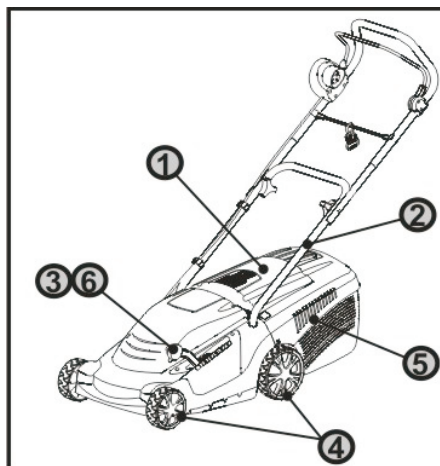

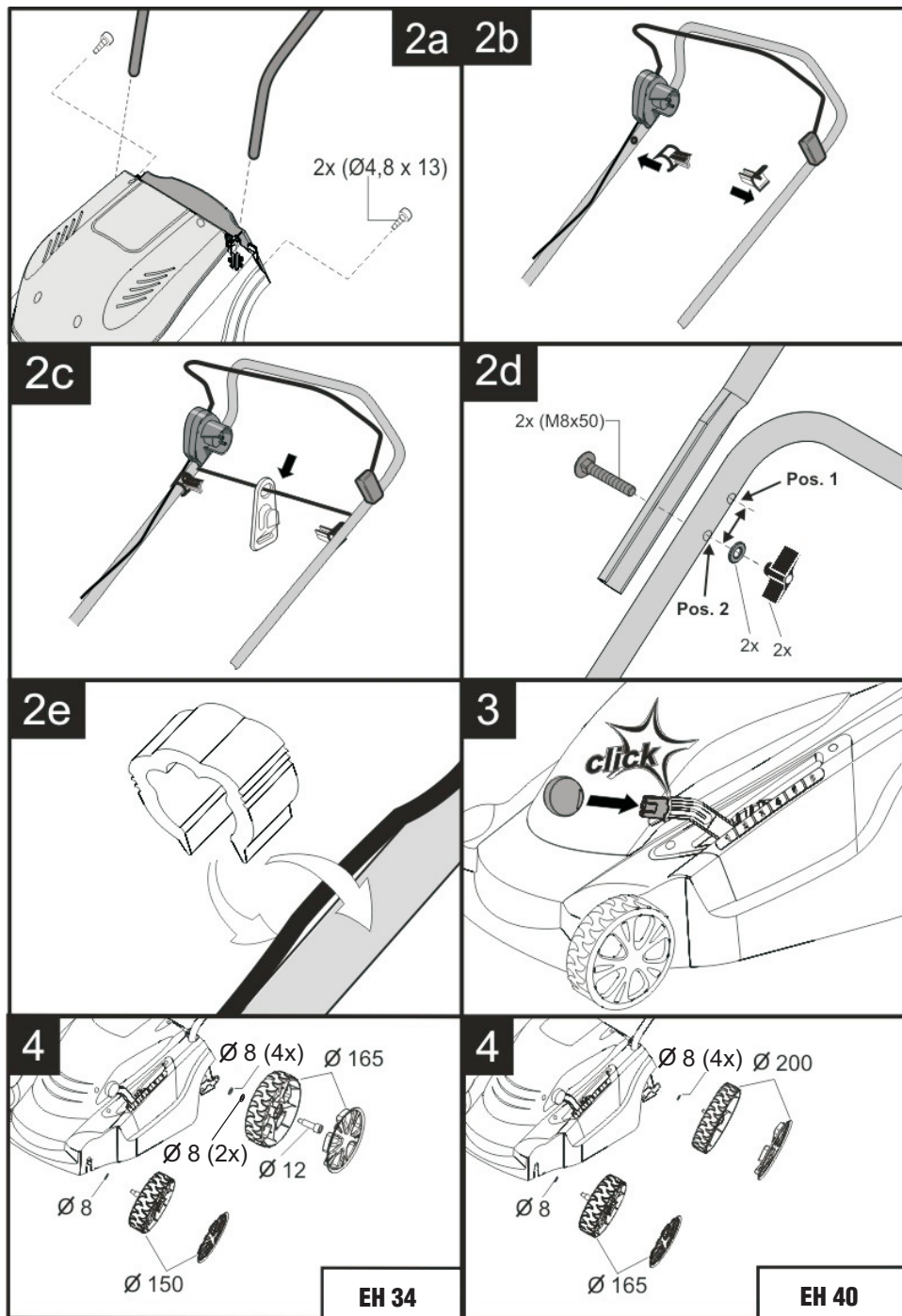

5a

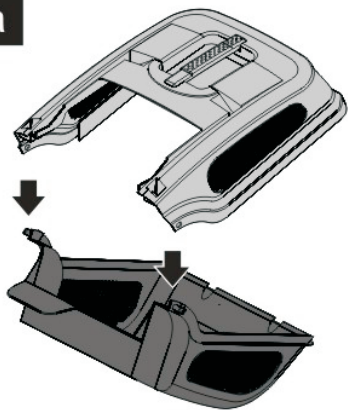

5b

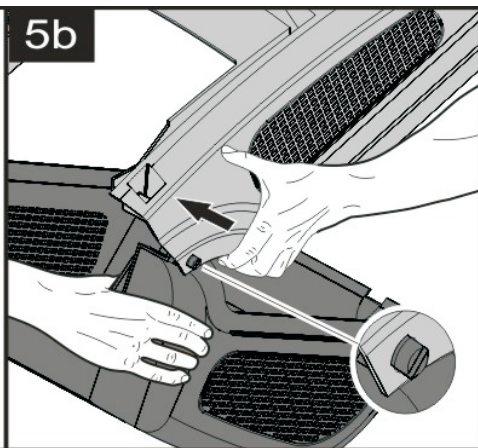

5c

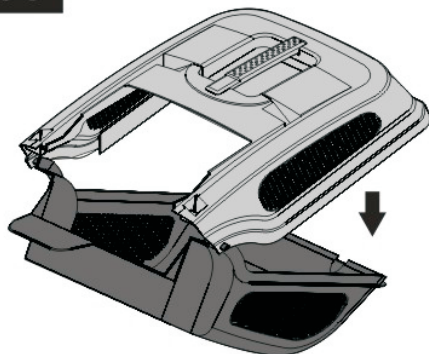



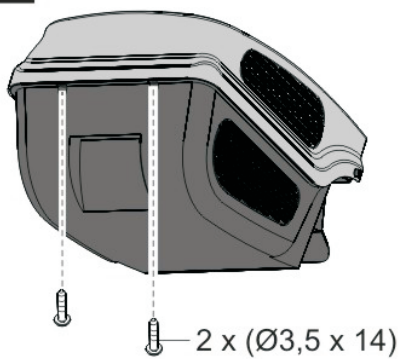



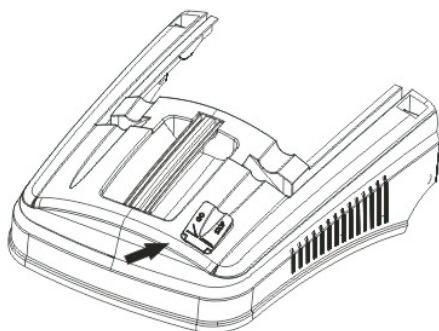
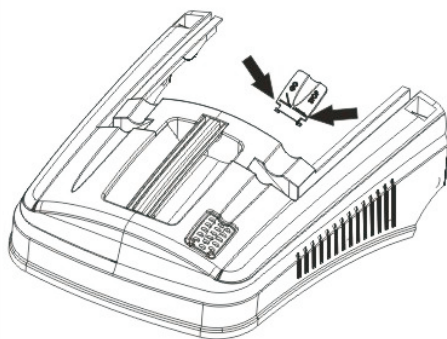

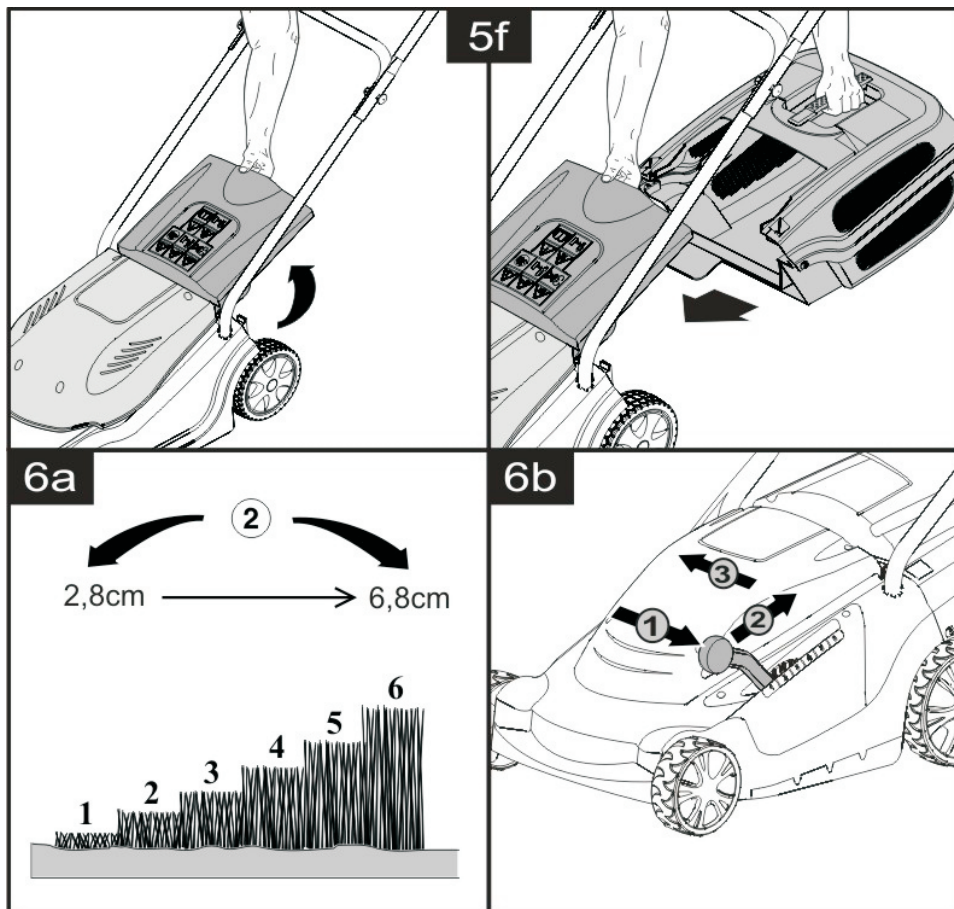



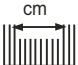

5d

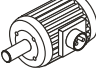

5e





 <b>i</b>	<b>PROFI LINE EH 34 (CL 34 E CP)</b>	<b>PROFI LINE EH 40 (CL 40 E CP)</b>
	ca. 1150x400x10	ca.1300x450x1050
	ca. 15 kg	ca. 19 kg
	34 cm	40 cm
	2,8 - 6,8 cm	2,8 - 6,8 cm
	ca. 37 l	ca.43 l
	230 V / 50 Hz	
	1200 W	1400 W
	2800 min <sup>-1</sup> ±100	
	L <sub>pa</sub> 80 dB(A)	L <sub>pa</sub> 84 dB(A)
	Gemessener Schalleistungspegel Niveau de puissance acoustique mesuré Livello di pressione acustica misurato L <sub>WA</sub> = 88 dB(A)	Gemessener Schalleistungspegel Niveau de puissance acoustique mesuré Livello di pressione acustica misurato L <sub>WA</sub> = 92 dB(A)
	Garantierter Schalleistungspegel Niveau de puissance acoustique garanti Livello di pressione acustica garantito L <sub>WA</sub> = 90 dB(A)	Garantierter Schalleistungspegel Niveau de puissance acoustique garanti Livello di pressione acustica garantito L <sub>WA</sub> = 94 dB(A)
	ISO 20643 a <sub>vhw</sub> 8m/s <sup>2</sup>	

**CE**-Konformitätserklärung: Wir erklären in alleiniger Verantwortung, dass dieses Produkt mit den folgenden Normen oder normativen Dokumenten übereinstimmt:  
EN 60335-1 • EN 60335-2-77 • 98/37/EG (...2009-12-28) •  
2006/42/EG (2009-12-29...) • 2006/95/EG • 2004/108/EG • 2000/14/EG

**MIGROS**



**Ausgediente Geräte nicht über den Hausmüll entsorgen!**

Verpackung, Gerät und Zubehör sind aus recyclingfähigen Materialien hergestellt und entsprechend zu entsorgen.



Vertrieb:

Migros-Genossenschafts-Bund, CH-8031 Zürich  
MIGROS-France S.A., F-74100 Etrembières  
MIGROS Betriebs GmbH, D-79539 Lörrach

Déclaration de conformité **CE**: nous déclarons sous notre propre responsabilité que ce produit est en conformité avec les normes ou documents normatifs suivants:  
EN 60335-1 • EN 60335-2-77 • 98/37/EG (...2009-12-28) •  
2006/42/EG (2009-12-29...) • 2006/95/EG • 2004/108/EG • 2000/14/EG

**MIGROS**



**Les appareils usagés ne doivent pas être mis au rebut avec les déchets ménagers!**

Les emballages, l'appareil et ses accessoires sont fabriqués en matériaux recyclables et sont à éliminer selon l'usage dans votre pays.



Distribution:

Migros-Genossenschafts-Bund, CH-8031 Zürich  
MIGROS-France S.A., F-74100 Etrembières  
MIGROS Betriebs GmbH, D-79539 Lörrach

Dichiarazione di conformità **CE**: ci assumiamo la piena responsabilità e dichiariamo che questo prodotto é conforme alle norme o ai documenti normativi seguenti:  
EN 60335-1 • EN 60335-2-77 • 98/37/EG (...2009-12-28) •  
2006/42/EG (2009-12-29...) • 2006/95/EG • 2004/108/EG • 2000/14/EG

**MIGROS**



**Non smaltire gli apparecchi usati con i rifiuti domestici!**

L'imballo, la macchina e gli accessori sono prodotti con un materiale che può essere riciclato e di conseguenza vanno smaltiti in modo appropriato.



Distribuzione:

Migros-Genossenschafts-Bund, CH-8031 Zürich  
MIGROS-France S.A., F-74100 Etrembières  
MIGROS Betriebs GmbH, D-79539 Lörrach

Im Interesse der technischen Weiterentwicklung sind Konstruktions- oder Ausführungsänderungen am Gerät vorbehalten.  
Toute modification de conception et de fabrication est réservée dans l'intérêt du progrès technique.  
Con riserva di modifiche di costruzione ed esecuzione dell'apparecchio dovute al progresso tecnico.

